

Antares 60

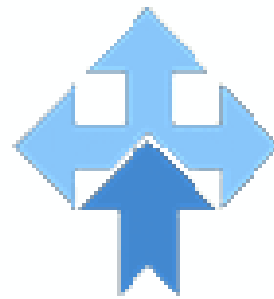

PIANA
compressed
air

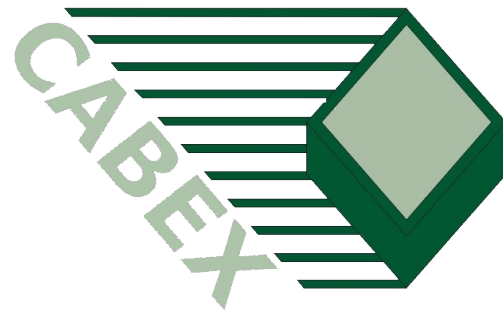

MATERIALS USED

- Diecast body of UNI 3715 alloy.
- Cups and drips-trais of GRILAMID high-resistance, shock-proof and splinter-proof, transparent plastic.
- Other parts are of DELRIN - ABS - NYLON V. and BRASS.
- Compensating springs are made of C72 STEEL and are locked, calibrated and tropicalized.

CONNECTIONS

- 1/2" gas.

FITTING

- Wall fitted by means of screws directly on the units or with brackets to be applied on the regulator.

PRESSURE

- Max 12 bar / 170 PSI. - low pressures on request.

TEMPERATURES

- Max 50° C / 120° F.

SURFACE FINISHING

- All the alloy components are treated, after manu-facturing, with oxideproofing and chrome plating, and lastly epossidic enamel stoved.

FLOW CHART

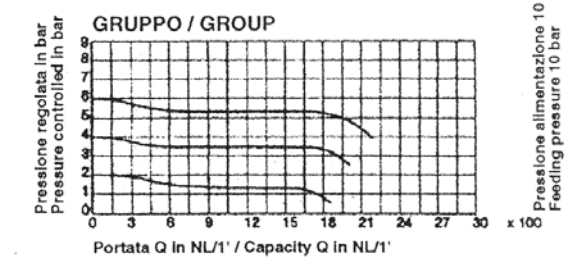
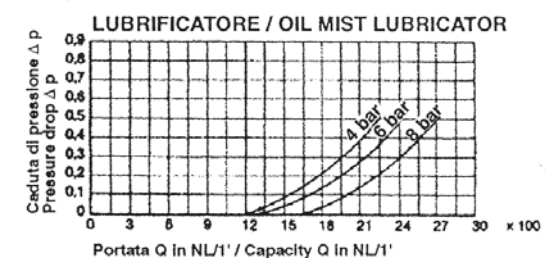
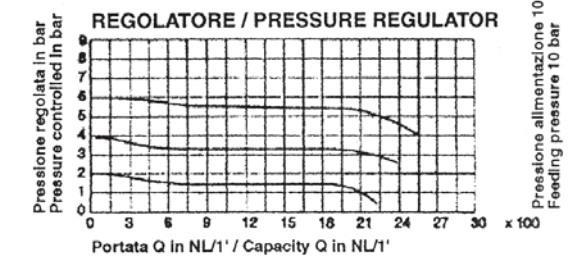
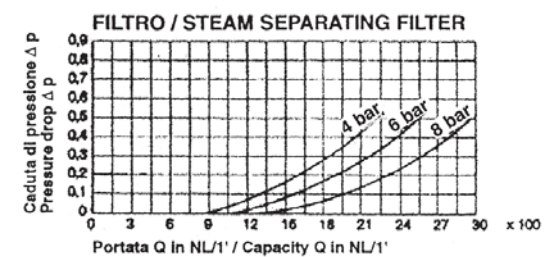

Antares 60

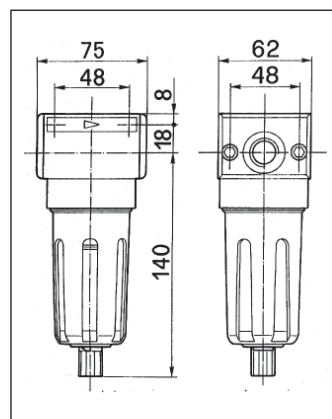

F60 TM STEAM SEPARATOR FILTER

42111813

Connectors
Cup capacity
Impurity zone
Filtration degree
Weight

1/2" gas
100 cc
60 cc
50 μ
880 g

Series semi-automatic drain

F60 / 38 Connectors
F60 / 12 Connectors
F60 / 34 Connectors

3/8" 42111803
1/2" 42111813
3/4" 42111823

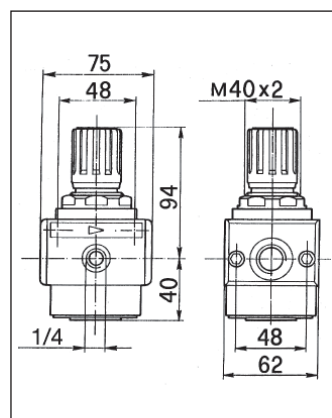

R60 PRESSURE REGULATOR

42131663

Connectors
Input pressure max
Output pressure
Weight

1/2" gas
24 bar
0 + 12 bar
1140 g

R60 / 38 Connectors
R60 / 38 SM without gauge
R60 / 12 Connectors
R60 / 12 SM without gauge
R60 / 34 Connectors
R60 / 34 SM without gauge

3/8" 42131683
42131673
1/2" 42131663
42131653
3/4" 42131703
42131693

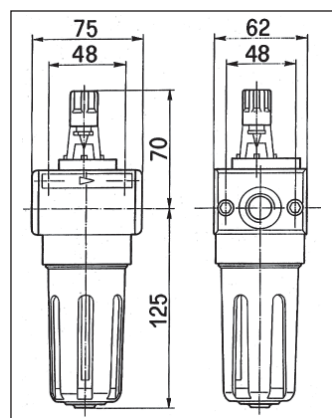

L60 TM OIL-MIST LUBRICATOR

42121663

Connectors
Cup capacity
Max oil level
Weight

1/2" gas
100 cc
90 cc
930 g

F60 / 38 Connectors
F60 / 12 Connectors
F60 / 34 Connectors

3/8" 42121653
1/2" 42121663
3/4" 42121673

LUBRICANTS ADVISED
(Viscos. 2° E a 50°C)

- BP ENERGOL HLP 22
- SHELL TELLUS 22
- ESSO SPINASSO 22
- MOBIL DTE 22

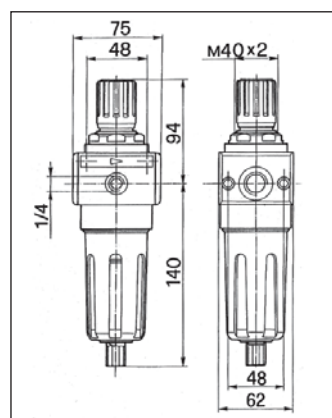

FR60 TM PRESSURE FILTER-REGULATOR

42141833

Connectors
Cup capacity
Impurity zone
Filtration degree
Input pressure max
Output pressure max
Weight

1/2" gas
100 cc
60 cc
50 μ
24 bar
0 + 12 bar
1250 g

FR60 / 38 Connectors
FR60 / 38 SM without gauge
FR60 / 12 Connectors
FR60 / 12 SM without gauge
FR60 / 34 Connectors
FR60 / 34 SM without gauge

3/8" 42141813
42141803
1/2" 42141833
42141823
3/4" 42141853
42141843



Antares 60

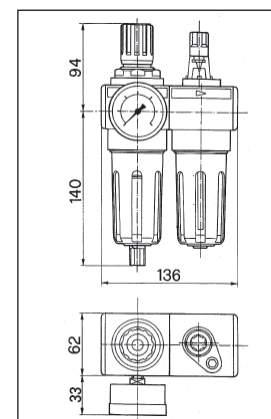

FR+L 60 TWO-UNIT COMPLETE GROUP

Connectors
Weight

2-60/38 (3/8" gas) **2-60/12** (1/2" gas)
2000 g

ASSEMBLY BY:

- **FR60** Pressure filter regulator
- **L60** Oil-mist lubricator

FR+L 60 / 38 Connectors
FR+L 60 / 38 SM without gauge
FR+L 60 / 12 Connectors
FR+L 60 / 12 SM without gauge
FR+L 60 / 34 Connectors
FR+L 60 / 34 SM without gauge

3/8" 42103813
42103803
1/2" 42103833
42103823
3/4" 42103853
42103843

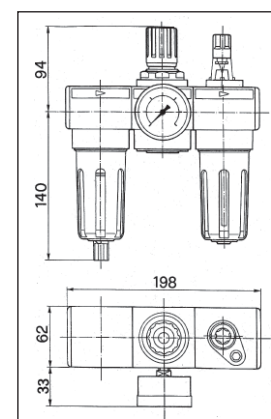

FRL 60 THREE-UNIT COMPLETE GROUP

Connectors
Weight

3-60/38 (3/8" gas) **3-60/12** (1/2" gas)
2600 g

ASSEMBLY BY:

- **F60** Steam separator filter
- **R60** Pressure regulator
- **L60** Oil-mist lubricator

FRL 60 / 38 Connectors
FRL 60 / 38 SM without gauge
FRL 60 / 12 Connectors
FRL 60 / 12 SM without gauge
FRL 60 / 34 Connectors
FRL 60 / 34 SM without gauge

3/8" 42103313
42103303
1/2" 42103333
42103323
3/4" 42103353
42103343

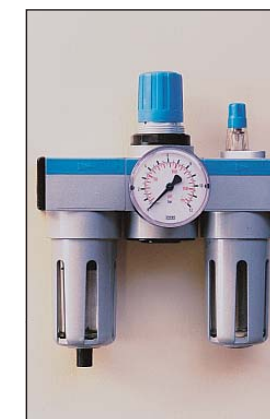

SPARE PARTS - ACCESSORIES

BRACKET FOR R60	32100163
ALUMINIUM RING NUT R60	24300801
METALLIC PROTECTION FL60	25208340
OR 128	37302541
BOWL F60	27402701
BOWL L60	27403001
PLASTIC PLAQUE F/R/L 60	37101341
PLASTIC SCREW COVER F/R/L 60	37101261

WARNING • The units must not be exposed to exhalations or be directly in contact with corrosive or flammable liquids: the transparent parts would be damaged. To clean cups use water and common household detergents. Unappropriate oils deteriorate the transparent material on the lubricator and the components downstream. Use only oils as specified.